

## Romney Court Shepherds Bush Green , London, W12 8PY

Located moments from Shepherds Bush central line station is this recently refurbished studio apartment.

The apartment is located on the third floor with lift access, in full it comprises, spacious living area/bedroom, modern kitchen and bathroom.

Council tax band A

**£1,450**

# Romney Court Shepherds Bush Green

, London, W12 8PY



**Directions**



Floor Plan

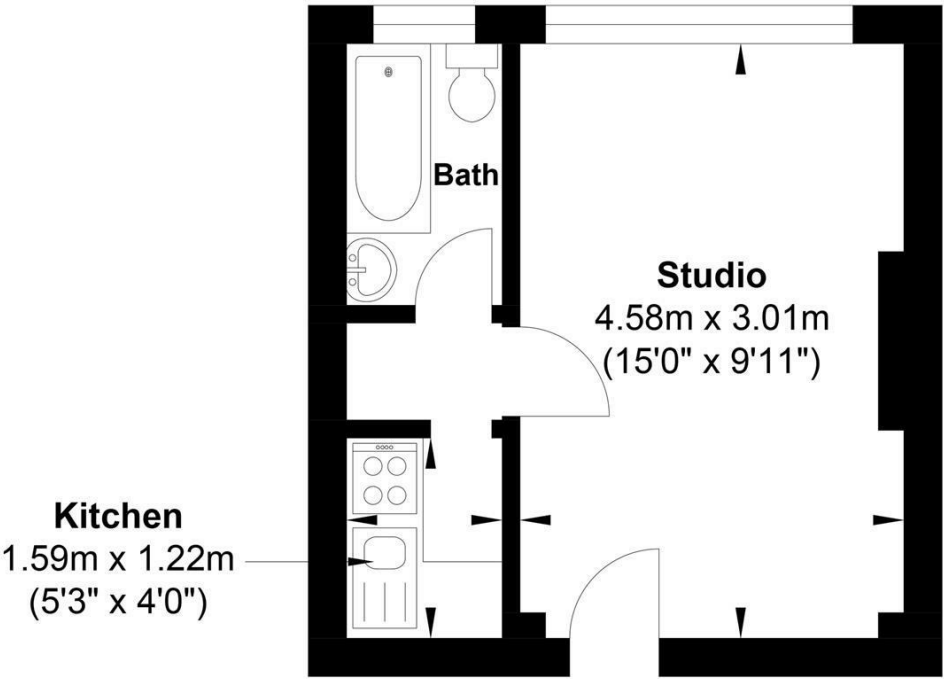

Third Floor

Gross Internal Floor Area : 20.3 m2 ... 218 ft2

Whilst every attempt has been made to ensure the accuracy of the floor plan contained here, measurements of doors, windows, rooms and any other items are approximate and no responsibility is taken for any error, omission, or mis-statement. This plan is for illustrative purposes only and should be used as such by any prospective purchaser. The services, systems and appliances shown have not been tested and no guarantee as to their operability or efficiency can be given.

These particulars, whilst believed to be accurate are set out as a general outline only for guidance and do not constitute any part of an offer or contract. Intending purchasers should not rely on them as statements of representation of fact, but must satisfy themselves by inspection or otherwise as to their accuracy. No person in this firms employment has the authority to make or give any representation or warranty in respect of the property.

